



LogStar
by BIGGEORGE

LogStar Park Budapest Városkapu

LogStar Park Budapest Városkapu is to be a 33,435 m² logistics park offering high quality warehouse and office space. The park itself is spread over two areas, with each of the areas containing two buildings.

While constructing LogStar Park Budapest Városkapu, modern logistics needs have been at the forefront of our minds. Therefore, the ideal conditions for national and international industrial and logistics companies are provided for.

LogStar Park Budapest Városkapu





LogStar is a member of Biggeorge Property and is responsible for the construction development and property management of logistics buildings. It has been recently created as an independent division of the company. One of its logistics development projects is the 72,000 m² BTS development for AUDI in Győr, which was acquired by AUDI after a temporary lease period. Biggeorge's current logistics portfolio includes a modern warehouse leased by German Rudolph Logistics in Győr, a building complex leased by Trans-Sped in Logistics Park Tata and logistics buildings in Illatos street and Megyeri street in Budapest.



The company's field of activity includes the development of commercial (office, hotel, retail, industrial/logistical) and residential real estates. In the course of the past few years, the company has gained significant experience in the area of plot development and the realization of infrastructural developments too.

Biggeorge Property Ltd. handles real estate development projects in the value of more than 150 billion HUF.

LOCATION



Budapest
Center
12 km



Liszt Ferenc
International
Airport
35 km



M3 1 km
M0 2 km
M2 5 km



International
Train Station
10 km

1152 Budapest,
Városcapu street 6
Városcapu street 14

LogStar Park Budapest Városcapu
offers a strategic location

as it is situated in Budapest's 15th district,
10 km north-east of the city centre. The site
is connected to national and international
traffic networks by motorways M0 and
M3, which are 1-3 minutes from the site.
The surroundings are characterized by
an active business life as several logistics,
commercial and service providers are
located in the area. Additionally, a diverse
qualified workforce is available in the
region.

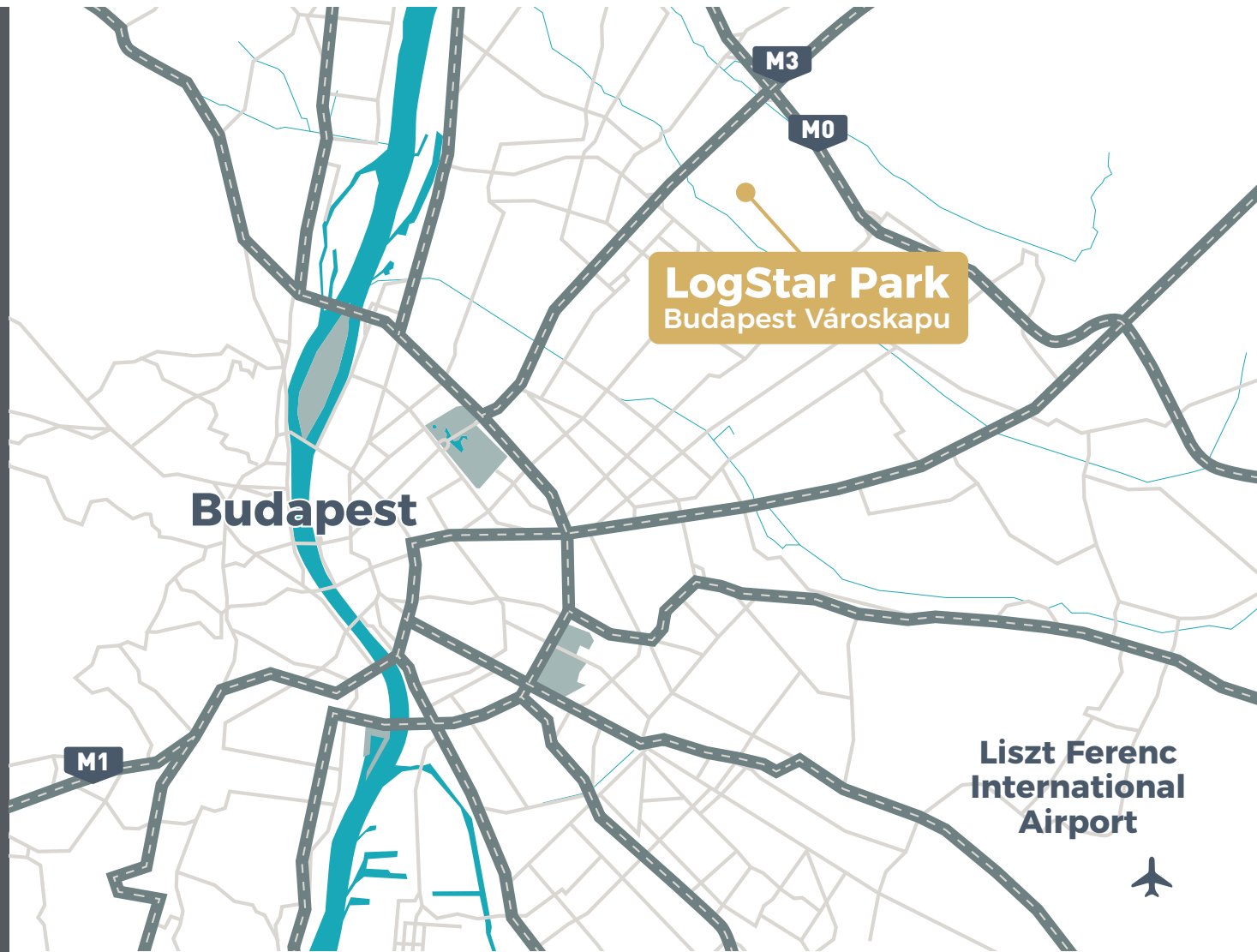

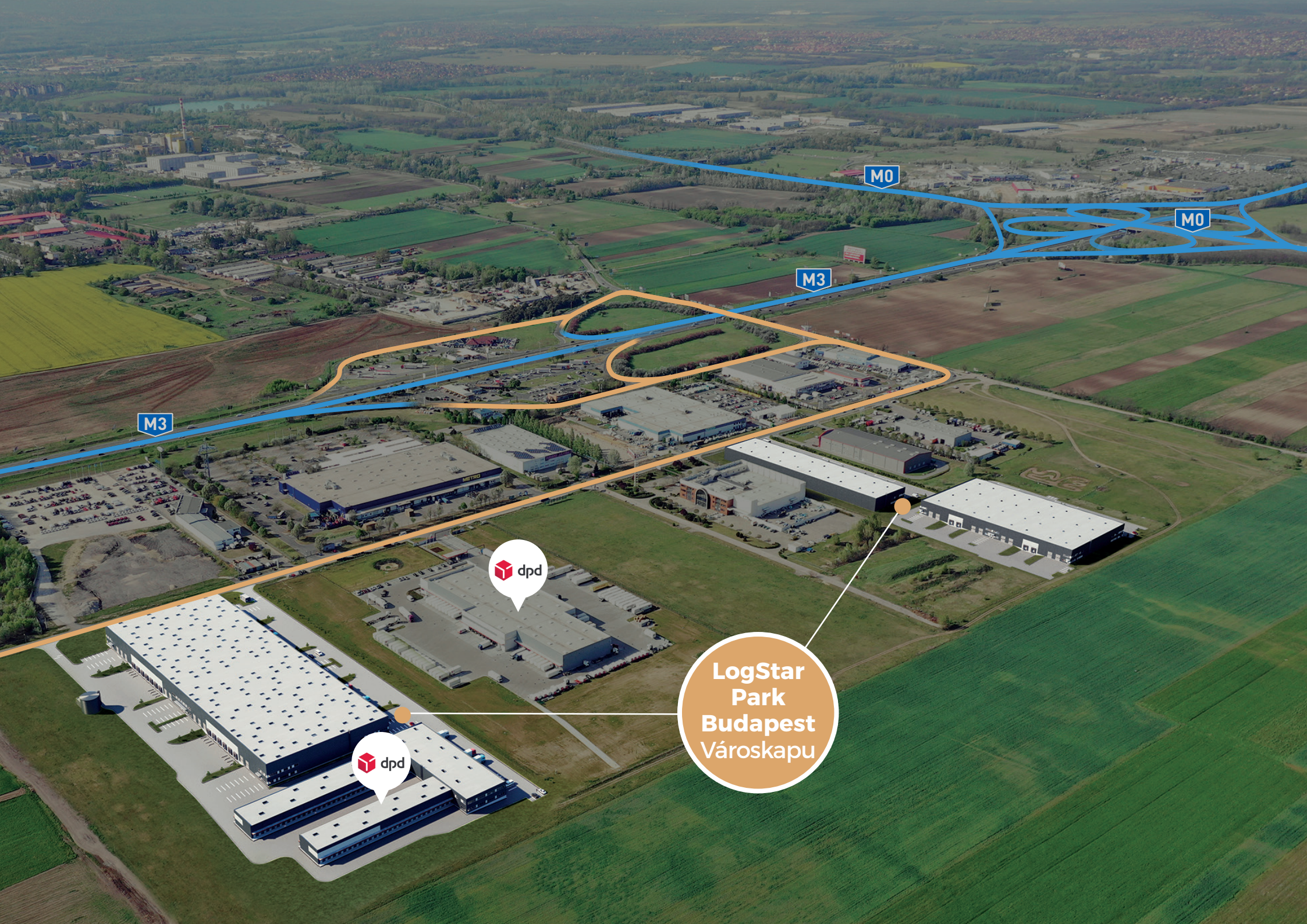

M3

M0

M3

M0



LogStar
Park
Budapest
Városcapu

SITEPLAN

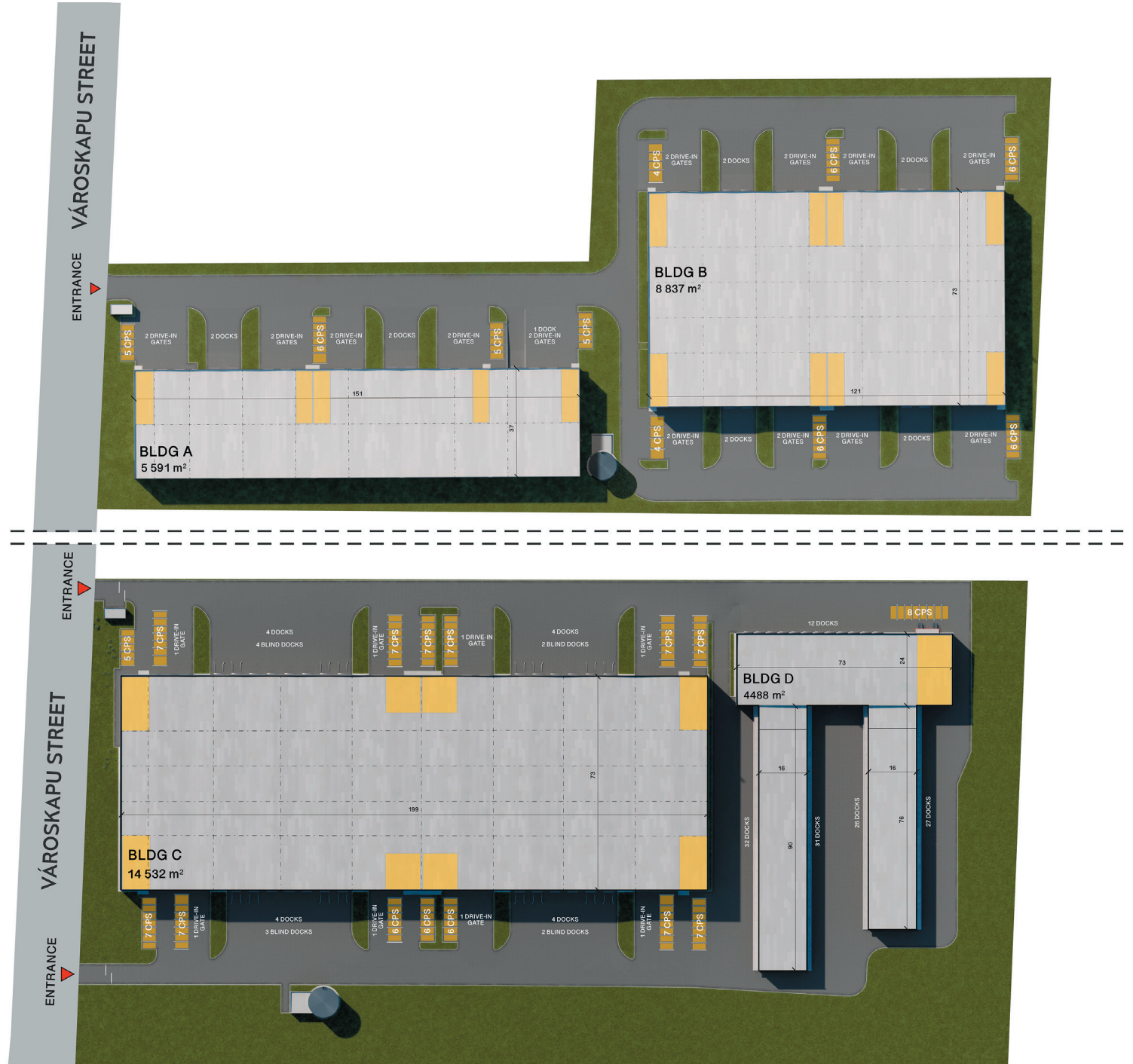

TECHNICAL SPECIFICATION

	A and B buildings	C building
Unit Size	400-8800 m ²	1000-14500 m ²
Clear Height	8 m	10 m
Floor Loading Capacity	5t /m ²	5t /m ²
Structure	Concrete/Steel	Concrete/Steel
Column Grid	Picking zone 18x18 m Warehouse area 18x18 m	Picking zone 18x24 m Warehouse area 12x24 m
Loading Docks	1 dock/ 1000 m ²	1 dock/ 850 m ²
Drive-in Gates	1 drive-in/ 500 m ²	1 drive-in/ 3000 m ²
Lighting	Energy efficient LED Picking zone 300 lux Warehouse area 200 lux	Energy efficient LED Picking zone 300 lux Warehouse area 200 lux
Heating	Black radiant	Black radiant
Sprinkler System	ESFR sprinkler	ESFR sprinkler
Fire Protection	According to fire regulation	According to fire regulation
Office	As required	As required
Metering	Smart metering	Smart metering
Security	CCTV	CCTV
Building Certificate	Photovoltaic system	Photovoltaic system
Services	Property management services	Property management services





LogStar
by BIGGEORGE

CONTACT

Klára Pásztor
Leasing Manager

+36 70 454 31 86
pasztor.klara@biggeorge.hu

Dóra Szakács
Leasing Coordinator

+36 70 454 40 33
szakacs.dora@biggeorge.hu



BIGGEORGE
PROPERTY